



The Exhibition

Ötzi,  
the Iceman  
An Amazing  
Experience



## The Exhibition

A modular format that may be customized to various exhibition spaces (up to 13,000 sq. ft.)  
Illustrated example: 8,600 sq. ft.

## The Site

Interactively explore an exact reconstruction of the discovery site, with the particularities of glacier archaeology.  
Feel the cold with haptics and other sensory perception.

## What He Had

A display of authentic objects approx. 5,300 years old from the original site, along with an explanation of the geographical surroundings, living area, life in the Alps.

## Mummies

A reconstruction of the Ötzi mummy, the process of mummification along with other original mummies.  
And an interactive scientist table with touchscreens and a chance to play researcher.

## Discovery

From the very first days of discovery up to conservation: the chronology of a unique archaeological find.

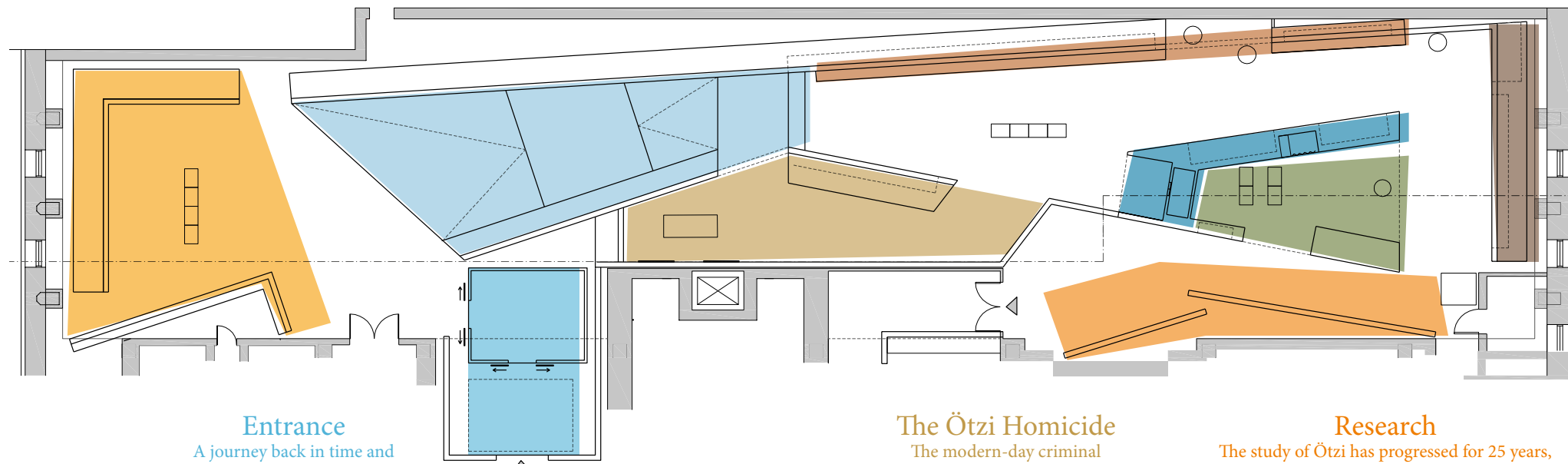

## Entrance

A journey back in time and through space with a cable car up to the main ridge of the Alps, complete with a timeline.

## The Ötzi Homicide

The modern-day criminal investigation into Ötzi's death: the crime lab, the criminal profile.  
Visitors can play detective or forensic scientist.

## Research

The study of Ötzi has progressed for 25 years, but international research continues.  
The researchers provide explanations in their own words through interviews, and new methods are tested on Ötzi.

## Ötzi's World

A vivid depiction of the Copper Age illustrated with actual findings.  
Exploration of everyday life:  
Where and how did the people live?  
What did they eat?  
What animals did they keep?  
How did their dwellings look?

## Reconstruction

The Iceman before mummification: based upon research, what did Ötzi look like?

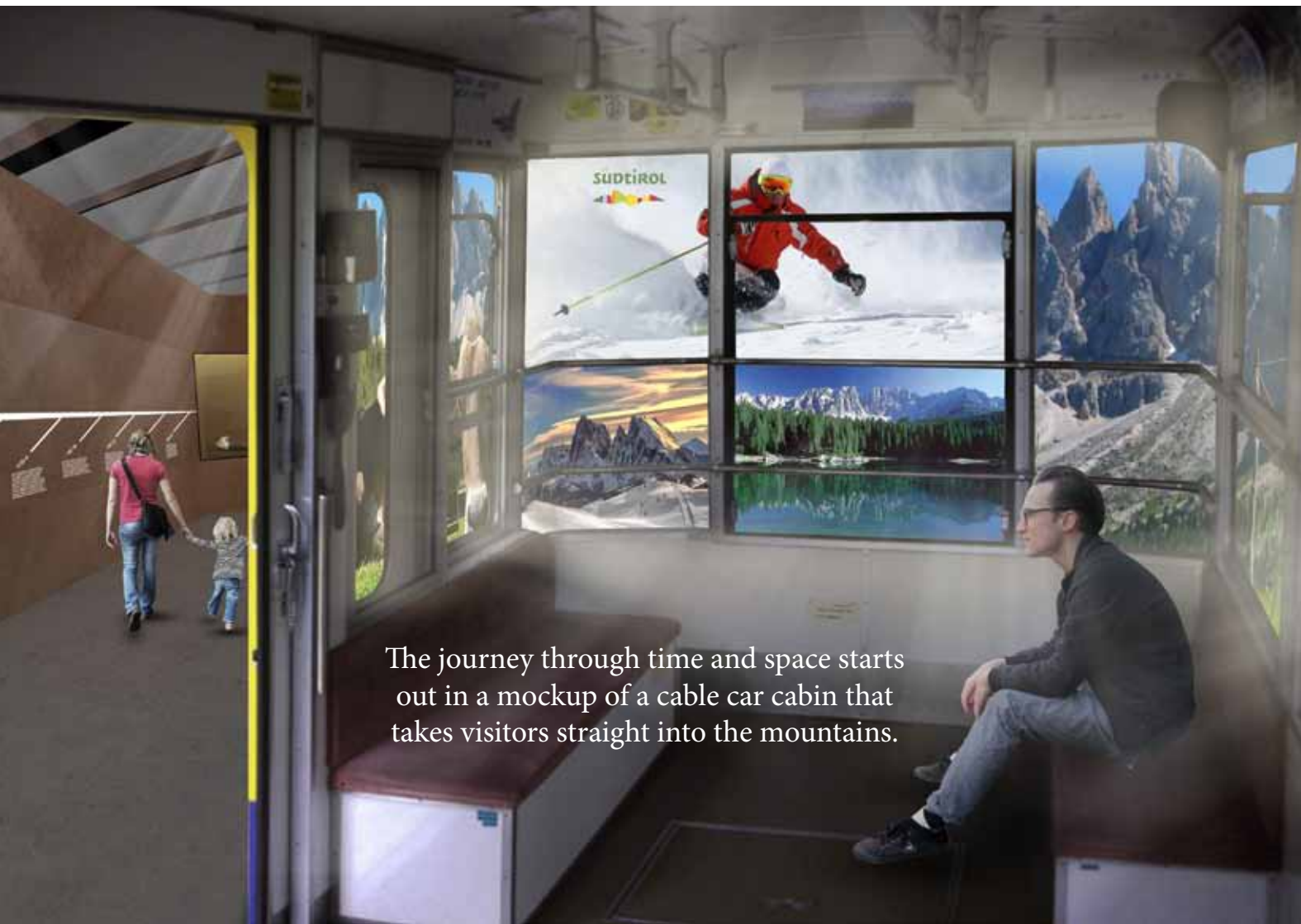

The journey through time and space starts out in a mockup of a cable car cabin that takes visitors straight into the mountains.



Snow and ice provide an authentic Ötzi experience.

Contemporary interior design with abundant use of stone and copper that also incorporates interactive areas.





Südtiroler Archäologiemuseum  
Museo Archeologico dell'Alto Adige  
South Tyrol Museum of Archaeology

### Scientific Organization

South Tyrol Museum of Archaeology  
Museumstraße/via Museo 43  
I-39100 Bolzano, Italy

Dr. Angelika Fleckinger  
Director  
T +39 0471 320112  
angelika.fleckinger@iceman.it

Dr. Andreas Putzer  
Curator  
T +39 0471 320117  
andreas.putzer@iceman.it

**MuseumsPartner**  
DIE KUNSTSPEDITION

### Information, Contacts and Bookings

Working with international museums, MuseumsPartner has produced numerous traveling exhibitions around the world. MuseumsPartner has collaborated with the South Tyrol Museum of Archaeology since 2003 in the production of traveling Iceman exhibitions.

Museumspartner GmbH  
Sebastian-Kneipp-Weg 17  
6020 Innsbruck, Austria  
T +43 512 562800  
www.museumspartner.com

Siegfried Brugger, CEO  
Peter Elsaesser, CEO  
T +43 664 2100673  
elsaesser@museumspartner.com

Petra Rotthoff, M.A.  
Director of Exhibitions  
T +49 170 3227029  
rotthoff@museumspartner.com

Heinz Reese  
MuseumsPartner North America  
T +1 250 531 0301  
reese@museumspartner.com

